



Blu-ray™ **VBR110** QUICKSTART GUIDE

PACKAGE CONTENTS

- VBR110 Blu-ray™ Disc Player
- Remote Control
- HDMI Cable
- 2 AA Batteries
- User Manual



DISC TYPES

THAT CAN BE PLAYED ON THIS BLU-RAY PLAYER

DISC TYPE	LOGO	DISC TYPE	LOGO
BLU-RAY™ DISC		DVD-R	
DVD-VIDEO (DVD-ROM)		AUDIO CDs (CDDA)	
DVD-RW		MP3 / JPEG / DATA CDs	

1 INSERT REMOTE CONTROL BATTERIES

Remove battery cover, then insert batteries matching + and - symbols. Replace battery cover.

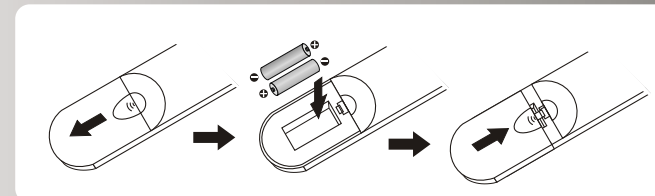

2 CONNECTING TO YOUR TV

Option A - HDMI Connection

High Quality Connection for best video and audio if your TV has an HDMI input connection as shown below.

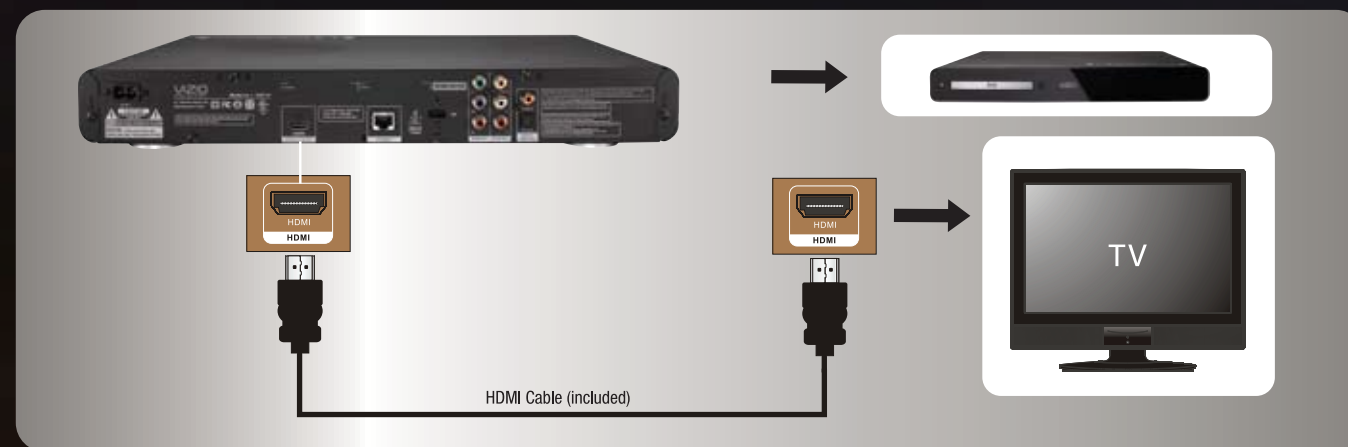

All devices should be turned off and disconnected from the power outlet before making connections.

CONTINUED ON BACK

ADD TO YOUR HOME THEATER EXPERIENCE
Visit www.VIZIO.com to review our full line of VIZIO-certified accessories or call 888-849-4623 for more information.

HIGH-DEFINITION SOUND - VSB210WS
Complete your total Home Theatre experience with stunning audio from VIZIO accessories such as the Sound Bar with Wireless Subwoofer.



37" LCD HDTV - SV370XVT
Enjoy crisp and clear video with a 120Hz refresh rate, 50,000:1 dynamic contrast ratio, and 1080P Full HD resolution - all in a stylish design only 2.2" thick.



REGISTER NOW
Register your product online today and receive the latest VIZIO news and special offers.
www.VIZIO.com

2 CONNECTING TO YOUR TV (Cont.)

Option B - Basic Audio & Video Connection
Connecting your TV using component video cables or AV cables.



Good picture and audio

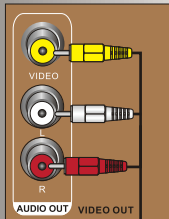

Better picture and good audio

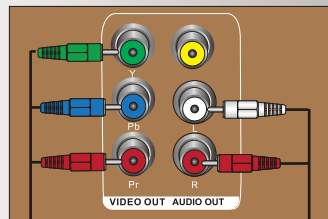

or

AV Cable (not included)

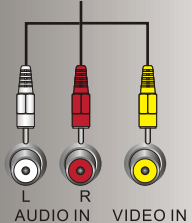

Component Video Cable (not included)

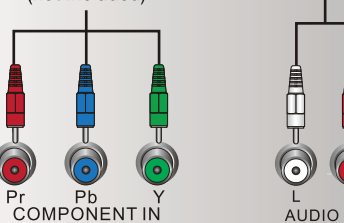

Audio Cable (not included)

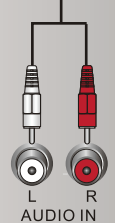

3 CONNECTING A USB DEVICE



The USB storage device should be 1GB or larger with at least 1 GB of free space and formatted FAT32.

NTFS and other file systems are not supported.

4 CONNECTING TO AN AUDIO SOURCE

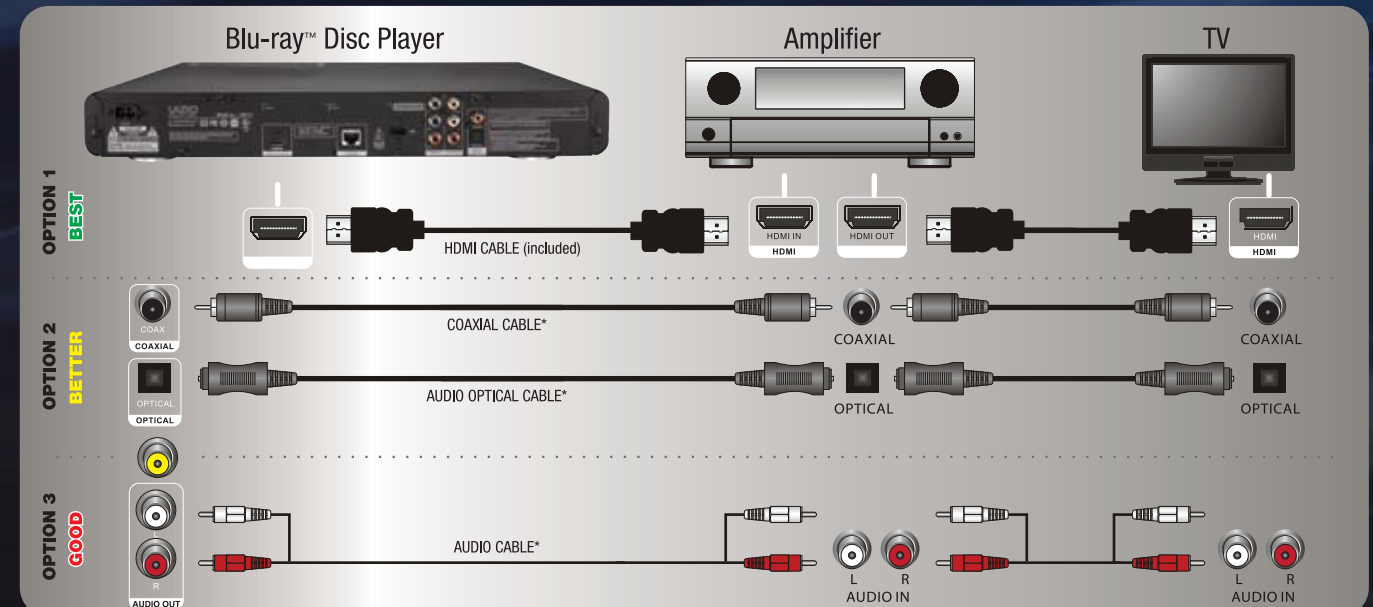

*Cables Not Included

5 CONNECT TO POWER & PLAY A DISC

1. Plug in the power cord, then press the POWER ON buttons on your Blu-ray DVD Player and your TV.
2. Select the correct input on your TV for your player (HDMI, Component, AV, etc.).
3. Press to open the disc tray.
4. Place a disc on the tray with the label facing up, then press to close the tray. It may take a few seconds for the disc to load.
5. Follow the on-screen instructions.

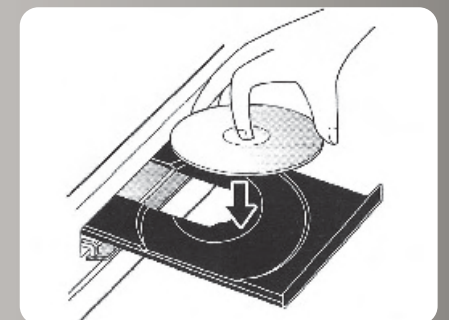

For further instructions or troubleshooting, consult the User's Manual.

6 ACCESSING BD-LIVE™ CONTENT

The Ethernet port is used to access BD-Live™ content. BD-Live™ is available on supported disc. Consult the documentation included with the Blu-ray disc. To access BD-Live™ content, you must have a USB storage device 1GB or larger formatted to FAT32 and broadband Internet access over an Ethernet connection such as cable or DSL. Dial-up Internet access is not supported.

